

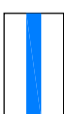

- LEGENDA :
-  PERIMETRO DEL P.I.I.
 -  EDIFICI OGGETTO DI INTERVENTO
 -  EDIFICI FUORI INTERVENTO

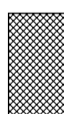

Antonio Citterio and Partners
 20122 - via Cerva 4 - Milano - Italia
 Tel + 39 02 7638801
 Fax + 39 02 76388080
<http://www.antonio-citterio.it>
info@antonio-citterioandpartners.it

Progetto nr: **05/2006**

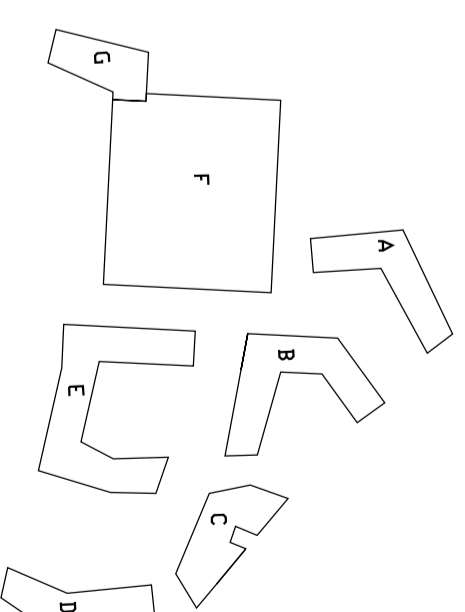
Committente
MORBEGNO 2000 S.r.l.
 Via Fabiani 19
 Morbegno (SO)

Progetto
COMUNE DI MORBEGNO (SO)
PROGRAMMA INTEGRATO
DI INTERVENTO
AREA EX-MARTINELLI

descrizione
STATO DI FATTO
RILEVIO PLANIMETRICO

disegnato da

scala
1:1000

sostituisce

data
NOVEMBRE 2006

aggiornamenti

tavola nr.

MO-MO-PII

B03

This is a proprietary drawing belonging to Antonio Citterio and Partners and cannot be reproduced or utilized by others without written authorization. All rights are reserved.

